

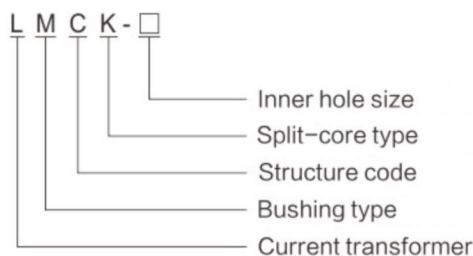

■ Meaning of Model



■ Description

LMCK series is a miniature current transformer . It has the characteristics of small size, light weight, and easy installation. Rated secondary output is mA, mV, 1A, or 5A. Inner hole size from 10mm to 50mm. The flame-retardant plastic housing, protected from moisture, stable in performance, and require no maintenance. When installing this product, it is strictly prohibited to open circuit secondary. After connecting the secondary circuit, CT should be hung on the bus or fixed with nylon tie.

■ Technical data

Working voltage : ≤660V

Working frequency : 50-60Hz

Environment temperature : -15℃~+40℃

Elevation : ≤1000m

Installation place : indoor

Specifications and models	mA and mV signal output			Rated secondary output load				Standard outgoing line
	Ratio	Rated load	Accuracy class	Ratio	0.5	1	3级	
LMCK-10	60A/100mA	10Ω	0.5					1.5m
	60A/50mA	10Ω	0.5					
	60A/0.333V	/	0.5					
LMCK-16	100A/100mA	10Ω	0.5					
	100A/50mA	10Ω	0.5					
	100A/0.333V	/	0.5					
LMCK-24	250A/100mA	20Ω	0.5	100A/5A				
	400A/100mA	20Ω	0.5	250A/5A		1VA	2.5VA	
	250A/0.333V	/	0.5	300A/5A		1.5VA	2.5VA	
	400A/0.333V	/	0.5	400A/5A	2.5VA	3.75VA	5VA	
LMCK-36	400A/100mA	20Ω	0.5	300A/5A		1.5VA	2.5VA	
	600A/100mA	20Ω	0.5	400A/5A	2.5VA	5VA	5VA	
	400A/0.333V	/	0.5	500A/5A	2.5VA	5VA		
	600A/0.333V	/	0.5	600A/5A	5VA	5VA		
LMCK-50	800A/100mA	30Ω	0.5/0.2	600A/5A	5VA	5VA		
	1000A/100mA	30Ω	0.5/0.2	800A/5A	7.5VA	10VA		
	800A/0.333V	/	0.5/0.2	1000A/5A	10VA	20VA		
	1000A/0.333V	/	0.5/0.2	1200A/5A	10VA	20VA		

Overall dimension drawing

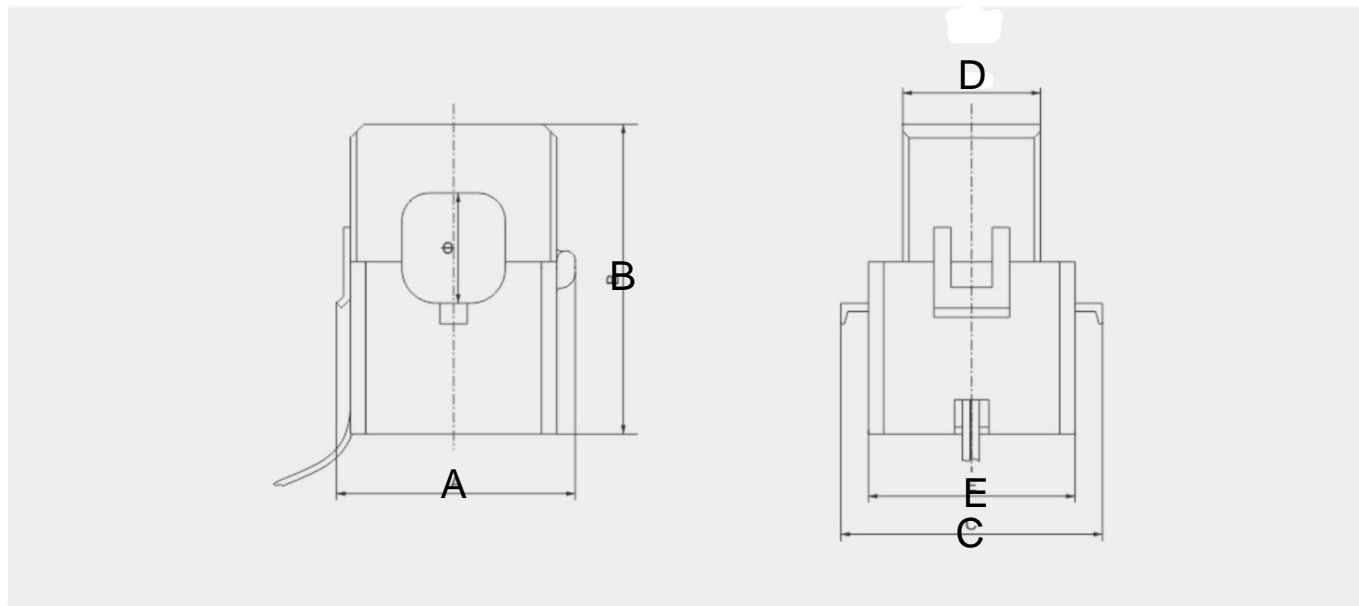

Models	Outline dimension(mm)					
	Φ	A	B	C	D	E
LMCK-10	10	29	41	/	14	26
LMCK-16	16	39	46	38	20	31
LMCK-24	24	54	66	43	23	35
LMCK-36	36	68	85	50	25	43
LMCK-50	50	93	120	70	28	60